



P. 4-19

## RACCORDI FILETTATI Threaded fittings

- Tutti gli elementi fusi sono realizzati in acciaio inox: 1.4408
  - Componenti di lega in %: C ≤ 0,07 · Cr 18,0 – 20,0 · Ni 9,0 – 12,0 · Mo 2,0 – 2,5
  - Le curve codice 6003 e i manicotti codici 6270 e 6272, sono realizzati in acciaio inox 1.4404 (AISI 316L)
  - Le unità con le sedi piatte sono dotate di guarnizione in PTFE
  - Tutti gli articoli sono contrassegnati con una pressione nominale di 150 lbs ~ 10,5 bar
  - Aree di applicazione dei materiali 1.4408 + 1.4404: acqua, acqua potabile, diverse sostanze chimiche, settore alimentare
  - Buona resistenza alla corrosione e agli acidi
  - Massima temperatura d'esercizio (senza ulteriore stress meccanico): 220°C
  - Filetti conformi alla norma DIN EN 10226-1 (ISO 7/1)
- All casted items are made of material 1.4408
  - Alloying components in %: C ≤ 0,07 · Cr 18,0 – 20,0 · Ni 9,0 – 12,0 · Mo 2,0 – 2,5
  - Bends Code 6003 as well as sockets Code 6270 and 6272 are made from material 1.4404 (AISI 316L)
  - Unions with flat seat are equipped with PTFE gaskets
  - All items are signed with pressure stages 150 lbs ~ 10,5 bar
  - Application areas of materials 1.4408 + 1.4404: water, drinking water, chemical substances, food sector
  - Good resistance against acids and corrosion
  - Maximum operating temperature (without further mechanical stress): 220°C
  - Connection threads according to DIN EN 10226-1 (ISO 7/1)



P. 20-21

## NIPPLI FILETTATI Threaded pipe Nipple

- Tutti i nippli per tubi filettati e i nippli a saldare sono realizzati dai tubi saldati (materiale 1.4404) secondo la norma DIN EN 10255 (dimensioni) e DIN EN 10241 (lunghezze)
  - Utilizzabili con acqua, acqua potabile e diverse sostanze chimiche
  - Pressione massima 50 bar (20 °C)
  - Filetti conformi alla norma DIN EN 10226-1 (ISO 7/1)
- All threaded pipe nipples and welding nipples are made from welded pipes (material 1.4404) according to DIN EN 10255 (dimensions) and DIN EN 10241 (length)
  - Suitable for media water, drinking water, different chemical substances
  - Maximum pressure stage 50 bar (20 °C)
  - Threads according to DIN EN 10226-1 (ISO 7/1)



P. 22

## FILTRO A „Y“ IN ACCIAIO INOX Y-Strainer made of stainless steel

NOVITÀ

- Estremità filettate femmina secondo DIN EN 10226-1 / ISO 7-1
  - Inserto filtrante con la guarnizione, disponibile come pezzo di ricambio
- Threaded female ends DIN EN 10226-1 / ISO 7-1
  - Screen insert with sealing as spare part available



P. 23-25

## VALVOLE A SFERA IN ACCIAIO INOX Ball Valves

- I corpi delle valvole sono realizzati in materiale CF8M, i materiali dei componenti sono elencati nella tabella
  - Tutte le valvole sono dotate di guarnizioni in PTFE
  - Tutte le valvole sono contrassegnate con il massimo valore di pressione consentito PN63
  - La relazione tra temperatura e pressione può essere estratta dai diagrammi
  - Area di applicazione: acqua e diverse sostanze chimiche
  - Buona resistenza alla corrosione e agli acidi
  - Tutte le valvole sono dotate di maniglia con bloccaggio di sicurezza
  - Filettature sono realizzate secondo DIN EN 10226-1 (ISO 7/1)
- Valves bodies are made from material CF8M, materials of the components are listed in table
  - All Valves are equipped with PTFE gaskets
  - All Valves are signed with the max. allowed pressure stages PN63
  - Temperature pressure relation can be taken out from diagrams
  - Application area: water and different chemical substances
  - Good resistance against corrosion and acids
  - All Valves are equipped with locking device
  - Threads according to DIN EN 10226-1 (ISO 7/1)



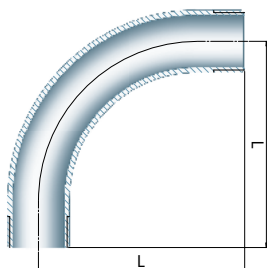

3		CURVA LARGA 90°, M/M Bend 90°, M/M				MAT. 1.4404	
MISURE [1X2]	CODICE	DIMENSIONI [MM]		PZ/SCATOLA	PZ/BUSTA	PESO [KG]	
Size [1x2]	Code	Dimensions [mm]		Pcs./Box	Pcs./Bags	Weight [Kg]	
		L					
1/4"	6003-014	60,0		50	5	0,0550	
3/8"	6003-038	70,0		50	5	0,0840	
1/2"	6003-012	80,0		50	5	0,1420	
3/4"	6003-034	100,0		50	2	0,2320	
1"	6003-100	120,0		50	2	0,4110	
1 1/4"	6003-114	140,0		10	1	0,6310	
1 1/2"	6003-112	160,0		8	1	0,8520	
2"	6003-200	190,0		5	1	1,3340	

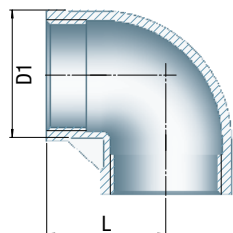

90		GOMITO 90°, F/F Elbows 90°, F/F				MAT. 1.4408	
MISURE [1X2]	CODICE	DIMENSIONI [MM]		PZ/SCATOLA	PZ/BUSTA	PESO [KG]	
Size [1x2]	Code	Dimensions [mm]		Pcs./Box	Pcs./Bags	Weight [Kg]	
		L	D1				
1/8"	6090-018	17,0	13,0	250	10	0,0223	
1/4"	6090-014	19,0	16,0	400	10	0,0338	
3/8"	6090-038	23,0	20,0	250	10	0,0537	
1/2"	6090-012	27,0	24,5	250	10	0,0630	
3/4"	6090-034	32,0	30,0	150	5	0,0960	
1"	6090-100	38,0	37,5	100	5	0,1651	
1 1/4"	6090-114	45,0	46,5	50	2	0,2558	
1 1/2"	6090-112	48,0	53,0	36	2	0,3558	
2"	6090-200	57,0	65,5	20	2	0,5616	
2 1/2"	6090-212	69,0	82,0	10	1	0,9218	
3"	6090-300	78,0	95,5	8	1	1,3832	
4"	6090-400	96,0	121,5	2	1	2,3373	

90		GOMITO 90°, F/F, RIDOTTO Reducing elbows 90°, F/F				MAT. 1.4408		
MISURE [1 X 2]	CODICE	DIMENSIONI [MM]				PZ/SCATOLA	PZ/BUSTA	PESO [KG]
Size [1 x 2]	Code	Dimensions [mm]				Pcs./Box	Pcs./Bags	Weight [Kg]
		L	L1	D1	D2			
1/2" x 3/8"	6090-012038	25,0	26,0	24,5	20,0	60	10	0,0600
3/4" x 3/8"	6090-034038	28,0	28,0	30,0	20,0	35	5	0,0700
3/4" x 1/2"	6090-034012	30,0	29,0	30,0	24,5	35	5	0,0776
1" x 1/2"	6090-100012	33,0	32,0	37,5	24,5	20	5	0,1090
1" x 3/4"	6090-100034	35,0	34,0	37,5	30,0	20	5	0,1200
1 1/4" x 3/4"	6090-114034	40,0	38,0	46,5	30,0	12	2	0,1803
1 1/4" x 1"	6090-114100	42,0	40,0	46,5	37,5	12	2	0,2194
1 1/2" x 1"	6090-112100	45,0	41,0	53,0	37,5	7	1	0,2638
1 1/2" x 1 1/4"	6090-112114	48,0	45,0	53,0	46,5	7	1	0,2872
2" x 1 1/4"	6090-200114	54,0	48,0	65,5	46,5	10	1	0,4100
2" x 1 1/2"	6090-200112	55,0	52,0	65,5	53,0	10	1	0,4383

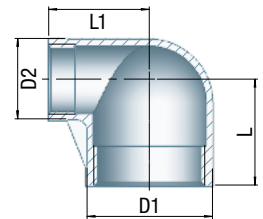

92		GOMITO 90°, M/F Street elbows 90°, M/F				MAT. 1.4408		
MISURE [1 X 2]	CODICE	DIMENSIONI [MM]				PZ/SCATOLA	PZ/BUSTA	PESO [KG]
Size [1 x 2]	Code	Dimensions [mm]				Pcs./Box	Pcs./Bags	Weight [Kg]
		L	D1					
1/8"	6092-018	17,0	13,0			250	10	0,0169
1/4"	6092-014	19,0	16,0			350	10	0,0286
3/8"	6092-038	23,0	20,0			250	10	0,0421
1/2"	6092-012	27,0	24,5			300	10	0,0574
3/4"	6092-034	32,0	30,0			150	5	0,0906
1"	6092-100	38,0	37,5			100	5	0,1449
1 1/4"	6092-114	45,0	46,5			50	2	0,2359
1 1/2"	6092-112	48,0	53,0			38	2	0,3093
2"	6092-200	57,0	65,5			18	2	0,5520
2 1/2"	6092-212	69,0	82,0			10	1	1,0775
3"	6092-300	78,0	95,5			6	1	1,4455
4"	6092-400	97,0	121,5			2	1	2,4285

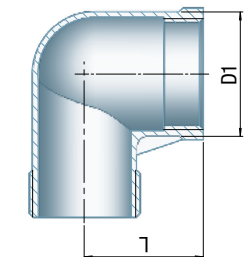

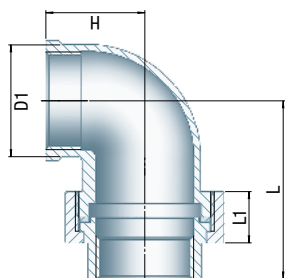

95

**GOMITO CON BOCCHETTONE A 90° F/F, SEDE PIANA**  
Union elbows, flat seat, F/F

**MAT. 1.4408**

MISURE [1X2]	CODICE	DIMENSIONI [MM]				PZ/SCATOLA	PZ/BUSTA	PESO [KG]
Size [1x2]	Code	Dimensions [mm]				Pcs./Box	Pcs./Bags	Weight [Kg]
		L	L1	D1	H			
1/4"	6095-014	46,5	13,5	16,0	17,0	50	5	0,0960
3/8"	6095-038	51,0	15,0	19,0	20,0	35	5	0,1280
1/2"	6095-012	56,0	16,0	26,0	27,0	25	5	0,1820
3/4"	6095-034	61,0	17,0	31,5	31,0	15	5	0,2780
1"	6095-100	70,5	20,0	39,0	36,0	14	2	0,3740
1 1/4"	6095-114	78,0	22,0	47,5	42,0	12	2	0,5810
1 1/2"	6095-112	83,0	24,0	54,0	46,0	20	2	0,7500
2"	6095-200	96,0	27,0	66,5	56,0	5	1	1,1250

96

**GOMITO CON BOCCHETTONE A 90° F/F, SEDE CONICA**  
Union elbows, conical seat, F/F

**MAT. 1.4408**

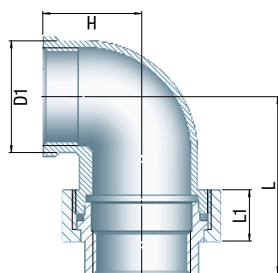

MISURE [1X2]	CODICE	DIMENSIONI [MM]				PZ/SCATOLA	PZ/BUSTA	PESO [KG]
Size [1x2]	Code	Dimensions [mm]				Pcs./Box	Pcs./Bags	Weight [Kg]
		L	L1	D1	H			
1/4"	6096-014	46,5	13,5	16,0	17,0	50	5	0,0960
3/8"	6096-038	51,0	15,0	19,0	20,0	35	5	0,1310
1/2"	6096-012	56,0	16,0	26,0	27,0	25	5	0,1820
3/4"	6096-034	61,0	17,0	31,5	31,0	15	5	0,2780
1"	6096-100	70,5	20,0	39,0	36,0	14	2	0,3740
1 1/4"	6096-114	78,0	22,0	47,5	42,0	12	2	0,5810
1 1/2"	6096-112	83,0	24,0	54,0	46,0	20	2	0,7500
2"	6096-200	96,0	27,0	66,5	56,0	5	1	1,1250



97

**GOMITO CON BOCCHETTONE A 90°, SEDE PIANA, M/F**  
Union elbows, flat seat, M/F

MAT. 1.4408

MISURE [1 X 2]	CODICE	DIMENSIONI [MM]				PZ/SCATOLA	PZ/BUSTA	PESO [KG]
Size [1 x 2]	Code	Dimensions [mm]				Pcs./Box	Pcs./Bags	Weight [Kg]
		L	L1	D1	H			
1/4"	6097-014	57,0	13,5	16,0	17,0	45	5	0,1040
3/8"	6097-038	62,0	15,0	19,0	20,0	30	5	0,1440
1/2"	6097-012	70,5	16,0	26,0	27,0	20	5	0,2160
3/4"	6097-034	76,5	17,0	31,5	31,0	15	5	0,3060
1"	6097-100	88,5	20,0	39,0	36,0	14	2	0,4220
1 1/4"	6097-114	100,0	22,0	47,5	42,0	10	2	0,6580
1 1/2"	6097-112	103,5	24,0	54,0	46,0	10	2	0,8460
2"	6097-200	121,0	27,0	66,5	56,0	2	2	1,2850

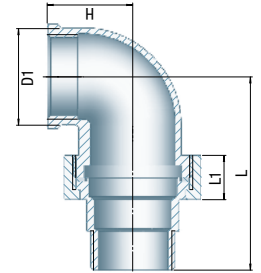

98

**GOMITO CON BOCCHETTONE A 90° M/F, SEDE CONICA**  
Union elbows, conical seat, M/F

MAT. 1.4408

MISURE [1 X 2]	CODICE	DIMENSIONI [MM]				PZ/SCATOLA	PZ/BUSTA	PESO [KG]
Size [1 x 2]	Code	Dimensions [mm]				Pcs./Box	Pcs./Bags	Weight [Kg]
		L	L1	D1	H			
1/4"	6098-014	57,0	13,5	16,0	17,0	45	5	0,1040
3/8"	6098-038	62,0	15,0	19,0	20,0	30	5	0,1440
1/2"	6098-012	70,5	16,0	26,0	27,0	20	5	0,2160
3/4"	6098-034	76,5	17,0	31,5	31,0	15	5	0,3060
1"	6098-100	88,5	20,0	39,0	36,0	14	2	0,4220
1 1/4"	6098-114	100,0	22,0	47,5	42,0	10	2	0,6580
1 1/2"	6098-112	103,5	24,0	54,0	46,0	10	2	0,8460
2"	6098-200	121,0	27,0	66,5	56,0	2	2	1,2850

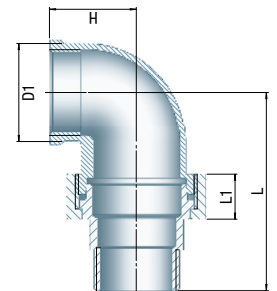



120		<b>GOMITO 45°, F/F</b> Elbows 45°, F/F				<b>MAT. 1.4408</b>	
MISURE [1X2]	CODICE	DIMENSIONI [MM]		PZ/SCATOLA	PZ/BUSTA	PESO [KG]	
Size [1x2]	Code	Dimensions [mm]		Pcs./Box	Pcs./Bags	Weight [Kg]	
		L	D1				
1/8"	6120-018	16,0	13,0	250	10		0,0220
1/4"	6120-014	17,0	16,0	250	10		0,0312
3/8"	6120-038	19,0	20,0	120	10		0,0417
1/2"	6120-012	21,0	24,5	100	10		0,0559
3/4"	6120-034	25,0	30,0	60	5		0,0789
1"	6120-100	29,0	37,5	50	5		0,1321
1 1/4"	6120-114	33,0	46,5	18	2		0,2023
1 1/2"	6120-112	37,0	53,0	14	2		0,2816
2"	6120-200	42,0	65,5	12	2		0,4435



121		<b>GOMITO 45°, M/F</b> Street elbows 45°, M/F				<b>MAT. 1.4408</b>	
MISURE [1X2]	CODICE	DIMENSIONI [MM]		PZ/SCATOLA	PZ/BUSTA	PESO [KG]	
Size [1x2]	Code	Dimensions [mm]		Pcs./Box	Pcs./Bags	Weight [Kg]	
		L	D1				
1/4"	6121-014	19,0	16,0	200	10		0,0304
3/8"	6121-038	23,0	20,0	120	10		0,0451
1/2"	6121-012	27,0	24,5	150	10		0,0578
3/4"	6121-034	32,0	30,0	35	5		0,0816
1"	6121-100	38,0	37,5	80	5		0,1515
1 1/4"	6121-114	45,0	46,5	12	2		0,2441
1 1/2"	6121-112	48,0	53,0	30	2		0,2843
2"	6121-200	57,0	65,5	16	2		0,4772

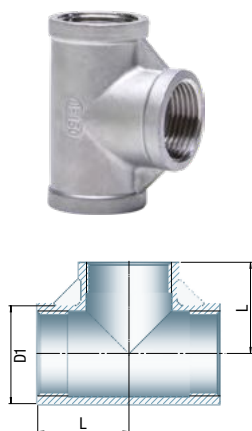

130		<b>TI A 90°, F/F/F</b> Tees 90°, F/F/F				<b>MAT. 1.4408</b>	
MISURE [1X2]	CODICE	DIMENSIONI [MM]		PZ/SCATOLA	PZ/BUSTA	PESO [KG]	
Size [1x2]	Code	Dimensions [mm]		Pcs./Box	Pcs./Bags	Weight [Kg]	
		L	D1				
1/8"	6130-018	17,0	13,0	110	10		0,0307
1/4"	6130-014	19,0	16,5	400	10		0,0466
3/8"	6130-038	23,0	20,0	300	10		0,0711
1/2"	6130-012	27,0	24,5	150	5		0,0883
3/4"	6130-034	32,0	30,0	80	5		0,1289
1"	6130-100	38,0	37,5	60	5		0,2096
1 1/4"	6130-114	45,0	46,5	40	2		0,3362
1 1/2"	6130-112	48,0	53,0	30	2		0,4445
2"	6130-200	57,0	65,5	18	2		0,7108
2 1/2"	6130-212	69,0	82,0	6	1		1,1861
3"	6130-300	78,0	95,5	5	1		1,7872

130		TI A 90°, F/F/F, RIDOTTO Reducing tees 90°, F/F/F				MAT. 1.4408		
MISURE [1 X 2]	CODICE	DIMENSIONI [MM]				PZ/SCATOLA	PZ/BUSTA	PESO [KG]
Size [1 x 2]	Code	Dimensions [mm]				Pcs./Box	Pcs./Bags	Weight [Kg]
		L	L1	D1	D2			
1/4" x 1/8"	6130-014018	18,0	18,0	16,0	13,0	100	10	0,0335
3/8" x 1/4"	6130-038014	20,0	22,0	20,0	16,0	70	10	0,0532
1/2" x 1/4"	6130-012014	24,0	24,0	24,5	16,0	35	5	0,0663
1/2" x 3/8"	6130-012038	26,0	25,0	24,5	20,0	35	5	0,0769
3/4" x 3/8"	6130-034038	28,0	28,0	30,0	20,0	20	5	0,1099
3/4" x 1/2"	6130-034012	29,0	30,0	30,0	24,5	40	5	0,1197
1" x 1/2"	6130-100012	32,0	33,0	37,5	24,5	30	5	0,1589
1" x 3/4"	6130-100034	34,0	35,0	37,5	30,0	15	5	0,1817
1 1/4" x 3/4"	6130-114034	38,0	40,0	46,5	30,0	10	2	0,2510
1 1/4" x 1"	6130-114100	40,0	42,0	46,5	37,5	10	2	0,2760
1 1/2" x 3/4"	6130-112034	37,0	43,0	53,0	30,0	6	2	0,2850
1 1/2" x 1"	6130-112100	41,0	45,0	53,0	37,5	6	2	0,3513
1 1/2" x 1 1/4"	6130-112114	45,0	48,0	53,0	46,5	6	2	0,3906
2" x 1"	6130-200100	44,0	51,0	65,5	37,5	9	1	0,4154
2" x 1 1/4"	6130-200114	48,0	54,0	65,5	46,5	9	1	0,5380
2" x 1 1/2"	6130-200112	52,0	55,0	65,5	53,0	9	1	0,5100

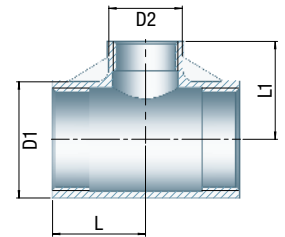

180		CROCE, F/F/F Crosses, F/F/F/F				MAT. 1.4408		
MISURE [1 X 2]	CODICE	DIMENSIONI [MM]				PZ/SCATOLA	PZ/BUSTA	PESO [KG]
Size [1 x 2]	Code	Dimensions [mm]				Pcs./Box	Pcs./Bags	Weight [Kg]
		L	D1					
1/8"	6180-018	17,0	13,0			120	10	0,0348
1/4"	6180-014	19,0	16,0			100	10	0,0536
3/8"	6180-038	23,0	20,0			30	10	0,0821
1/2"	6180-012	27,0	24,5			25	5	0,1000
3/4"	6180-034	32,0	30,0			15	5	0,1510
1"	6180-100	38,0	37,5			12	2	0,2553
1 1/4"	6180-114	45,0	46,5			10	2	0,4452
1 1/2"	6180-112	48,0	53,0			8	2	0,5183
2"	6180-200	57,0	65,5			8	2	0,8898

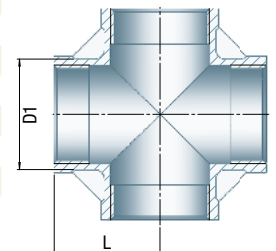



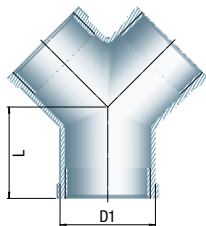

220		DISTRIBUZIONE A Y, F/F/F Y-type tee, F/F/F				MAT. 1.4408	
MISURE [1x2]	CODICE	DIMENSIONI [MM]			PZ/SCATOLA	PZ/BUSTA	PESO [KG]
Size [1x2]	Code	Dimensions [mm]			Pcs./Box	Pcs./Bags	Weight [Kg]
		L	D1				
1/4"	6220-014	19,0	18,0		75	5	0,0446
3/8"	6220-038	23,0	21,5		60	10	0,0694
1/2"	6220-012	27,0	26,5		30	5	0,0834
3/4"	6220-034	32,0	32,0		15	5	0,1288
1"	6220-100	40,9	43,2		25	5	0,3091
1 1/4"	6220-114	45,0	49,0		14	2	0,3434
1 1/2"	6220-112	48,0	55,5		10	2	0,4498
2"	6220-200	57,0	68,5		5	1	0,7185

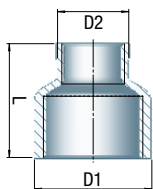

240		MANICOTTO RIDOTTO, F/F Reducing sockets, F/F				MAT. 1.4408	
MISURE [1x2]	CODICE	DIMENSIONI [MM]			PZ/SCATOLA	PZ/BUSTA	PESO [KG]
Size [1x2]	Code	Dimensions [mm]			Pcs./Box	Pcs./Bags	Weight [Kg]
		L	D1	D2			
1/4" x 1/8"	6240-014018	25,0	17,5	14,0	250	10	0,0211
3/8" x 1/8"	6240-038018	23,0	21,0	14,0	180	10	0,0197
3/8" x 1/4"	6240-038014	26,0	21,0	17,5	180	10	0,0262
1/2" x 1/8"	6240-012018	34,0	26,5	14,0	120	10	0,0455
1/2" x 1/4"	6240-012014	34,0	26,5	17,5	120	10	0,0499
1/2" x 3/8"	6240-012038	34,0	26,5	21,0	120	10	0,0513
3/4" x 1/8"	6240-034018	36,0	32,0	14,0	75	5	0,0520
3/4" x 1/4"	6240-034014	36,0	32,0	17,5	75	5	0,0659
3/4" x 3/8"	6240-034038	36,0	32,0	21,0	75	5	0,0550
3/4" x 1/2"	6240-034012	36,0	32,0	25,5	150	5	0,0732
1" x 3/8"	6240-100038	42,0	39,0	21,0	45	5	0,1078
1" x 1/2"	6240-100012	42,0	39,0	25,5	180	5	0,1101
1" x 3/4"	6240-100034	42,0	39,0	31,0	90	5	0,1244
1 1/4" x 1/2"	6240-114012	48,0	48,0	25,5	30	5	0,1541
1 1/4" x 3/4"	6240-114034	48,0	48,0	31,0	30	5	0,1634
1 1/4" x 1"	6240-114100	48,0	48,0	39,0	60	5	0,1744
1 1/2" x 1/2"	6240-112012	52,0	54,0	25,5	25	5	0,1550
1 1/2" x 3/4"	6240-112034	52,0	54,0	31,0	25	5	0,1620
1 1/2" x 1"	6240-112100	52,0	54,0	39,0	50	5	0,2429
1 1/2" x 1 1/4"	6240-112114	52,0	54,0	48,0	50	5	0,1800
2" x 1/2"	6240-200012	58,0	67,5	25,5	25	5	0,2248
2" x 3/4"	6240-200034	58,0	67,5	31,0	24	2	0,3290
2" x 1"	6240-200100	58,0	67,5	39,0	12	2	0,3474
2" x 1 1/4"	6240-200114	58,0	67,5	48,0	50	5	0,3603
2" x 1 1/2"	6240-200112	58,0	67,5	54,0	25	5	0,3451
2 1/2" x 1 1/2"	6240-212112	65,0	84,0	54,0	10	2	0,4697
2 1/2" x 2"	6240-212200	65,0	84,0	67,5	10	2	0,5665
3" x 2"	6240-300200	72,0	98,0	67,5	8	1	0,8005
3" x 2 1/2"	6240-300212	72,0	98,0	84,0	8	1	0,8556
4" x 2"	6240-400200	94,0	125,0	67,5	10	1	1,0094
4" x 2 1/2"	6240-400212	94,0	125,0	84,0	10	1	1,0277
4" x 3"	6240-400300	94,0	125,0	98,0	10	1	1,0885

241

**RIDUZIONE, M/F**  
Hexagon bushings, M/F

**MAT. 1.4408**

MISURE [1 X 2]	CODICE	DIMENSIONI [MM]		PZ/SCATOLA	PZ/BUSTA	PESO [KG]
Size [1 x 2]	Code	Dimensions [mm]		Pcs./Box	Pcs./Bags	Weight [Kg]
		L	SW			
1/4" x 1/8"	6241-014018	16,0	14,0	250	10	0,0086
3/8" x 1/8"	6241-038018	16,5	18,0	200	10	0,0168
3/8" x 1/4"	6241-038014	16,5	18,0	400	10	0,0138
1/2" x 1/8"	6241-012018	20,0	22,0	175	5	0,0301
1/2" x 1/4"	6241-012014	20,0	22,0	700	5	0,0228
1/2" x 3/8"	6241-012038	20,0	22,0	700	5	0,0194
3/4" x 1/8"	6241-034018	21,0	27,5	125	5	0,0400
3/4" x 1/4"	6241-034014	21,0	27,5	125	5	0,0452
3/4" x 3/8"	6241-034038	21,0	27,5	125	5	0,0375
3/4" x 1/2"	6241-034012	21,0	27,5	500	5	0,0309
1" x 1/4"	6241-100014	24,5	34,5	75	5	0,0768
1" x 3/8"	6241-100038	24,5	34,5	75	5	0,0962
1" x 1/2"	6241-100012	24,5	34,5	300	5	0,0781
1" x 3/4"	6241-100034	24,5	34,5	300	5	0,0535
1 1/4" x 3/8"	6241-114038	27,5	43,0	50	5	0,1143
1 1/4" x 1/2"	6241-114012	27,5	43,0	50	5	0,1390
1 1/4" x 3/4"	6241-114034	27,5	43,0	100	5	0,0951
1 1/4" x 1"	6241-114100	27,5	43,0	200	5	0,0863
1 1/2" x 3/8"	6241-112038	28,5	49,0	70	5	0,2120
1 1/2" x 1/2"	6241-112012	28,5	49,0	35	5	0,1940
1 1/2" x 3/4"	6241-112034	28,5	49,0	35	5	0,1677
1 1/2" x 1"	6241-112100	28,5	49,0	150	5	0,1250
1 1/2" x 1 1/4"	6241-112114	28,5	49,0	150	5	0,0969
2" x 1/2"	6241-200012	33,0	61,0	22	2	0,2240
2" x 3/4"	6241-200034	33,0	61,0	22	2	0,2300
2" x 1"	6241-200100	33,0	61,0	90	2	0,2210
2" x 1 1/4"	6241-200114	33,0	61,0	90	2	0,2310
2" x 1 1/2"	6241-200112	33,0	61,0	90	2	0,2020
2 1/2" x 1"	6241-212100	37,0	76,0	12	2	0,3280
2 1/2" x 1 1/4"	6241-212114	37,0	76,0	12	2	0,3210
2 1/2" x 1 1/2"	6241-212112	37,0	76,0	12	2	0,3200
2 1/2" x 2"	6241-212200	37,0	76,0	48	2	0,3520
3" x 1 1/4"	6241-300114	40,0	90,0	15	1	0,4720
3" x 1 1/2"	6241-300112	40,0	90,0	15	1	0,5030
3" x 2"	6241-300200	40,0	90,0	30	1	0,5100
3" x 2 1/2"	6241-300212	40,0	90,0	15	1	0,4690
4" x 2"	6241-400200	46,0	115,0	10	1	1,7112
4" x 2 1/2"	6241-400212	46,0	115,0	10	1	0,8320
4" x 3"	6241-400300	46,0	115,0	10	1	0,9829

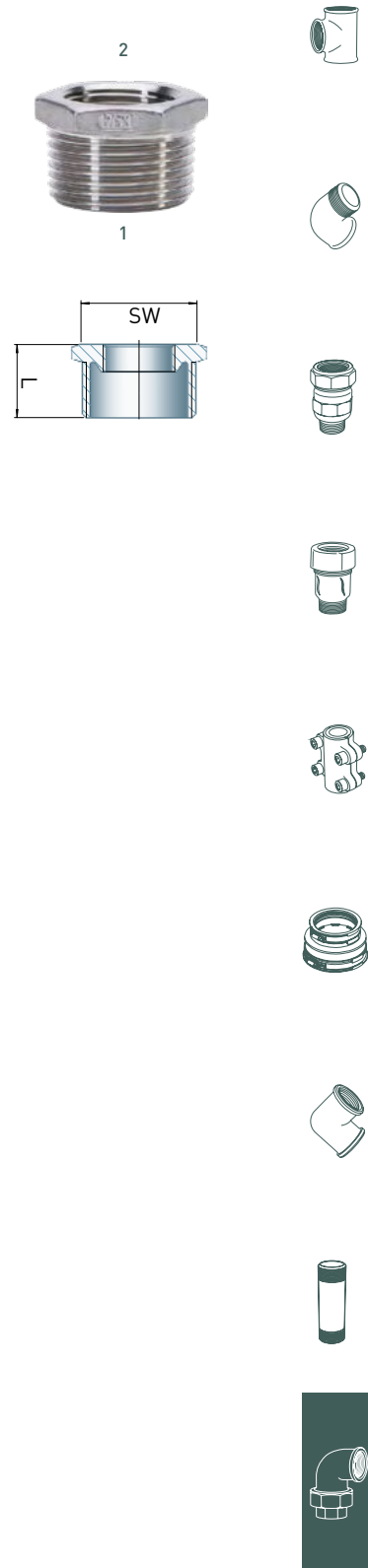

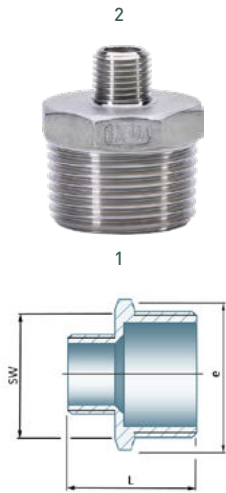

245		NIPPLO RIDOTTO M/M Hexagon reducing nipples, M/M				MAT, 1,4408	
MISURE [ 1x2 ]	CODICE	DIMENSIONI [MM]			PZ/SCATOLA	PZ/BUSTA	PESO [KG]
Size [ 1x2 ]	Code	Dimensions [mm]			Pcs./Box	Pcs./Bags	Weight [Kg]
		L	e	SW			
1/4" x 1/8"	6245-014018	22,5	17,3	15,0	370	10	0,0131
3/8" x 1/8"	6245-038018	24,0	20,8	18,0	250	10	0,0250
3/8" x 1/4"	6245-038014	26,5	20,8	18,0	250	10	0,0210
1/2" x 1/8"	6245-012018	27,5	25,4	22,0	150	5	0,0289
1/2" x 1/4"	6245-012014	30,0	25,4	22,0	150	5	0,0320
1/2" x 3/8"	6245-012038	30,5	25,4	22,0	300	5	0,0322
3/4" x 1/4"	6245-034014	31,5	32,3	28,0	75	5	0,0457
3/4" x 3/8"	6245-034038	32,0	32,3	28,0	75	5	0,0466
3/4" x 1/2"	6245-034012	35,5	32,3	28,0	300	5	0,0536
1" x 1/4"	6245-100014	34,5	40,4	35,0	55	5	0,0802
1" x 3/8"	6245-100038	35,0	40,4	35,0	55	5	0,0968
1" x 1/2"	6245-100012	38,5	40,4	35,0	110	5	0,0853
1" x 3/4"	6245-100034	39,5	40,4	35,0	220	5	0,0890
1 1/4" x 1/2"	6245-114012	41,5	50,2	43,5	30	2	0,1172
1 1/4" x 3/4"	6245-114034	42,5	47,1	43,5	30	2	0,1193
1 1/4" x 1"	6245-114100	45,0	50,2	43,5	120	2	0,1286
1 1/2" x 1/2"	6245-112012	41,5	57,2	49,5	18	2	0,1448
1 1/2" x 3/4"	6245-112034	42,5	57,2	49,5	18	2	0,1443
1 1/2" x 1"	6245-112100	45,0	57,2	49,5	74	2	0,1573
1 1/2" x 1 1/4"	6245-112114	47,5	57,2	49,5	36	2	0,1440
2" x 1/2"	6245-200012	46,5	71,6	62,0	12	2	0,2667
2" x 3/4"	6245-200034	47,5	71,6	62,0	12	2	0,2471
2" x 1"	6245-200100	50,0	71,6	62,0	24	2	0,2520
2" x 1 1/4"	6245-200114	52,5	67,1	62,0	24	2	0,2720
2" x 1 1/2"	6245-200112	52,5	71,6	62,0	50	2	0,2400
2 1/2" x 1 1/2"	6245-212112	54,5	89,5	77,5	6	2	0,4349
2 1/2" x 2"	6245-212200	59,0	81,5	77,5	24	2	0,4542
3" x 1 1/2"	6245-300112	58,0	95,1	90,5	10	1	0,4400
3" x 2"	6245-300200	62,5	104,5	90,5	10	1	0,6333
3" x 2 1/2"	6245-300212	64,5	104,5	90,5	10	1	0,6142
4" x 2"	6245-400200	69,0	125,6	116,0	5	1	1,1329
4" x 2 1/2"	6245-400212	71,0	121,9	116,0	5	1	1,0444
4" x 3"	6245-400300	74,0	125,6	116,0	5	1	0,8480

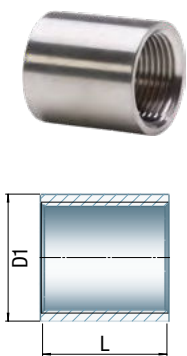

270		MANICOTTO, F/F Sockets, F/F, full length (pipe made)				MAT, 1,4404	
MISURE [ 1x2 ]	CODICE	DIMENSIONI [MM]			PZ/SCATOLA	PZ/BUSTA	PESO [KG]
Size [ 1x2 ]	Code	Dimensions [mm]			Pcs./Box	Pcs./Bags	Weight [Kg]
		L	D1				
1/8"	6270-018	17,0	14,0		250	10	0,0120
1/4"	6270-014	25,0	18,5		800	10	0,0260
3/8"	6270-038	26,0	21,3		370	10	0,0340
1/2"	6270-012	34,0	26,4		450	5	0,0570
3/4"	6270-034	36,0	31,8		300	5	0,0760
1"	6270-100	43,0	39,5		180	5	0,1300
1 1/4"	6270-114	48,0	48,3		100	5	0,1930
1 1/2"	6270-112	48,0	54,5		70	5	0,2200
2"	6270-200	56,0	66,3		45	5	0,3260
2 1/2"	6270-212	65,0	82,0		24	2	0,4490
3"	6270-300	71,0	95,0		16	1	0,5710
4"	6270-400	83,0	122,0		10	1	0,9220

272		MEZZO MANICOTTO, F/F Sockets, F/F, half length (pipe made)				MAT, 1,4404	
MISURE [1 X 2]	CODICE	DIMENSIONI [MM]			PZ/SCATOLA	PZ/BUSTA	PESO [KG]
Size [1 x 2]	Code	Dimensions [mm]			Pcs./Box	Pcs./Bags	Weight [Kg]
		L	D1				
1/8"	6272-018	10,0	14,0		500	10	0,0080
1/4"	6272-014	11,0	18,5		450	10	0,0140
3/8"	6272-038	12,0	21,3		350	10	0,0180
1/2"	6272-012	15,0	26,4		400	5	0,0290
3/4"	6272-034	17,0	31,8		300	5	0,0410
1"	6272-100	19,5	39,5		175	5	0,0670
1 1/4"	6272-114	22,0	48,3		100	5	0,0980
1 1/2"	6272-112	22,0	54,5		140	5	0,1120
2"	6272-200	26,0	66,3		90	5	0,1660
2 1/2"	6272-212	30,5	82,0		10	2	0,2310
3"	6272-300	34,0	95,0		15	1	0,2860
4"	6272-400	39,0	122,0		10	1	0,4710

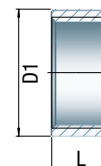

280		NIPPLO, M/M Hexagon nipples, M/M			MAT, 1,4408		
MISURE [1 X 2]	CODICE	DIMENSIONI [MM]			PZ/SCATOLA	PZ/BUSTA	PESO [KG]
Size [1 x 2]	Code	Dimensions [mm]			Pcs./Box	Pcs./Bags	Weight [Kg]
		L	L1	SW			
1/8"	6280-018	20,0	8,0	11,0	370	10	0,0077
1/4"	6280-014	25,0	10,5	15,0	750	10	0,0153
3/8"	6280-038	27,0	11,0	18,0	500	10	0,0223
1/2"	6280-012	34,0	14,5	22,0	600	10	0,0372
3/4"	6280-034	36,5	15,5	28,0	300	5	0,0620
1"	6280-100	42,0	18,0	35,0	200	5	0,0960
1 1/4"	6280-114	47,5	20,5	43,5	120	2	0,1421
1 1/2"	6280-112	17,5	20,5	49,5	74	2	0,1688
2"	6280-200	57,0	25,0	62,0	50	2	0,2867
2 1/2"	6280-212	61,0	27,0	77,5	24	1	0,4433
3"	6280-300*	67,5	30,0	90,5	20	1	0,6266
4"	6280-400*	80,0	36,0	117,0	10	1	1,0431

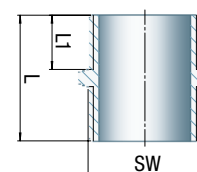

Codice art. con \*  
nipplo decagonale

290		TAPPO ESAGONALE CON BORDO Hexagon plugs			MAT, 1,4408		
MISURE [1 X 2]	CODICE	DIMENSIONI [MM]			PZ/SCATOLA	PZ/BUSTA	PESO [KG]
Size [1 x 2]	Code	Dimensions [mm]			Pcs./Box	Pcs./Bags	Weight [Kg]
		L	SW				
1/8"	6290-018	12,0	11,0		500	10	0,0042
1/4"	6290-014	14,5	15,0		370	10	0,0085
3/8"	6290-038	16,0	18,0		500	10	0,0127
1/2"	6290-012	19,5	22,0		800	5	0,0213
3/4"	6290-034	21,0	28,0		400	5	0,0323
1"	6290-100	24,0	35,0		300	5	0,0553
1 1/4"	6290-114	27,0	43,5		130	5	0,0828
1 1/2"	6290-112	27,0	49,5		120	5	0,1054
2"	6290-200	32,0	62,0		80	5	0,1889
2 1/2"	6290-212	34,0	77,5		14	2	0,3961
3"	6290-300	37,5	90,5		20	1	0,5711
4"	6290-400	44,0	117,0		7	1	1,0587

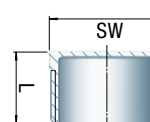

esagono: misure da 1/8" a 1/2"  
ottagono: dimensioni 3/4" - 2"  
decagono: misure da 2 1/2" a 4"

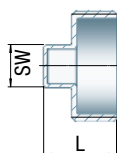

291		TAPPO SENZA BORDO Square plugs				MAT, 1,4408	
MISURE [1x2]	CODICE	DIMENSIONI [MM]		PZ/SCATOLA	PZ/BUSTA	PESO [KG]	
Size [1x2]	Code	Dimensions [mm]		Pcs./Box	Pcs./Bags	Weight [Kg]	
		L	SW				
1/8"	6291-018	11,0	6,0	500	10		0,0044
1/4"	6291-014	13,5	7,0	500	10		0,0055
3/8"	6291-038	15,0	8,0	370	10		0,0072
1/2"	6291-012	18,5	10,0	500	5		0,0128
3/4"	6291-034	21,0	12,0	150	5		0,0184
1"	6291-100	25,5	14,0	180	5		0,0332
1 1/4"	6291-114	28,8	16,0	50	5		0,0801
1 1/2"	6291-112	29,0	20,0	35	5		0,0662
2"	6291-200	34,5	22,0	50	5		0,1206
2 1/2"	6291-212	38,5	28,0	12	2		0,2695
3"	6291-300	41,5	32,0	16	1		0,3925
4"	6291-400	51,5	40,0	10	1		0,7877

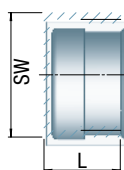

decagono: misure da 2 1/2" a 4"

300		CALOTTA ESAGONALE Hexagon caps				MAT, 1,4408	
MISURE [1x2]	CODICE	DIMENSIONI [MM]		PZ/SCATOLA	PZ/BUSTA	PESO [KG]	
Size [1x2]	Code	Dimensions [mm]		Pcs./Box	Pcs./Bags	Weight [Kg]	
		L	SW				
1/8"	6300-018	12,5	13,5	370	10		0,0107
1/4"	6300-014	16,0	17,0	250	10		0,0164
3/8"	6300-038	16,5	20,5	150	10		0,0220
1/2"	6300-012	21,0	25,0	400	5		0,0376
3/4"	6300-034	22,5	31,0	200	5		0,0603
1"	6300-100	26,0	38,0	200	5		0,0816
1 1/4"	6300-114	29,0	47,0	150	5		0,1310
1 1/2"	6300-112	29,0	53,0	100	5		0,1854
2"	6300-200	33,5	66,0	70	5		0,2560
2 1/2"	6300-212	38,5	82,0	14	2		0,4800
3"	6300-300	42,0	95,5	10	1		0,7530
4"	6300-400	48,5	121,5	7	1		1,3468

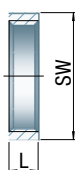

310		CONTRODADO ESAGONALE Hexagon back nuts				MAT, 1,4408	
MISURE [1x2]	CODICE	DIMENSIONI [MM]		PZ/SCATOLA	PZ/BUSTA	PESO [KG]	
Size [1x2]	Code	Dimensions [mm]		Pcs./Box	Pcs./Bags	Weight [Kg]	
		L	SW				
1/8"	6310-018	5,0	15,0	500	10		0,0046
1/4"	6310-014	6,0	18,0	500	10		0,0069
3/8"	6310-038	6,0	22,0	500	10		0,0095
1/2"	6310-012	7,0	27,0	600	10		0,0161
3/4"	6310-034	7,0	32,0	250	5		0,0167
1"	6310-100	9,0	40,0	200	5		0,0342
1 1/4"	6310-114	11,0	48,0	100	5		0,0489
1 1/2"	6310-112	11,0	55,0	300	5		0,0634
2"	6310-200	13,0	68,0	35	5		0,1103
2 1/2"	6310-212	15,0	85,0	30	2		0,1734
3"	6310-300	17,0	100,0	50	2		0,2802
4"	6310-400	20,0	125,0	24	2		0,4375

**315** **RACCORDO PORTAGOMMA, MASCHIO** **MAT, 1,4408**  
Hexagon hose nipples

MISURE [1x2]	CODICE	DIMENSIONI [MM]					PZ/SCATOLA	PZ/BUSTA	PESO [KG]
Size [1x2]	Code	Dimensions [mm]					Pcs./Box	Pcs./Bags	Weight [Kg]
		L	L1	d1	d2	SW			
1/8" x 7 mm	6315-1807	33,0	19,0	3,2	6,0	11,0	250	10	0,0110
1/4" x 9 mm	6315-1409	42,5	28,0	5,0	9,0	15,0	200	10	0,0182
3/8" x 11 mm	6315-3811	49,0	33,0	7,0	11,0	18,0	120	10	0,0281
1/2" x 13 mm	6315-1213	59,5	38,0	8,0	13,0	22,0	500	10	0,0525
3/4" x 20 mm	6315-3420	66,0	45,0	15,0	20,0	28,0	250	5	0,0753
1" x 25 mm	6315-1025	75,0	48,0	20,0	25,0	36,0	150	5	0,1392
1 1/4" x 33 mm	6315-11433*	79,0	52,0	27,5	33,0	43,5	100	2	0,1745
1 1/2" x 40 mm	6315-11240*	83,0	56,0	34,0	40,0	49,5	72	2	0,1998
2" x 52 mm	6315-2052	92,0	60,0	45,0	52,0	62,0	30	2	0,3305
2 1/2" x 63,5 mm	6315-212635*	100,0	62,5	56,0	63,5	77,5	15	1	0,6808
3" x 76,5 mm	6315-30765*	110,0	70,0	67,0	76,5	90,5	12	1	0,9785
4" x 100 mm	6315-40100*	120,0	73,0	90,0	100,0	117,0	4	1	1,4330



Codice art. con \* raccordo portagomma decagonale

**330** **BOCCHETTONE A SEDE PIANA, F/F** **MAT, 1,4408**  
Unions flat seat, F/F

MISURE [1x2]	CODICE	DIMENSIONI [MM]					PZ/SCATOLA	PZ/BUSTA	PESO [KG]
Size [1x2]	Code	Dimensions [mm]					Pcs./Box	Pcs./Bags	Weight [Kg]
		L	L1						
1/8"	6330-018	30,0	13,0				50	10	0,0400
1/4"	6330-014	33,5	13,5				50	10	0,0580
3/8"	6330-038	36,5	15,0				50	5	0,0780
1/2"	6330-012	39,5	16,0				200	5	0,1220
3/4"	6330-034	42,5	17,0				140	5	0,1650
1"	6330-100	50,0	20,0				84	2	0,2480
1 1/4"	6330-114	54,0	22,0				45	5	0,3480
1 1/2"	6330-112	58,0	24,0				45	5	0,5160
2"	6330-200	65,0	27,0				24	2	0,7760
2 1/2"	6330-212	75,0	29,5				5	1	1,2000
3"	6330-300	83,0	31,0				5	1	1,5920
4"	6330-400	110,0	34,0				4	1	2,4800

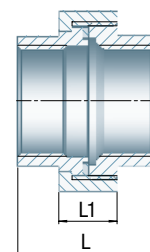

**331** **BOCCHETTONE A SEDE PIANA, M/F** **MAT, 1,4408**  
Unions flat seat, M/F

MISURE [1x2]	CODICE	DIMENSIONI [MM]					PZ/SCATOLA	PZ/BUSTA	PESO [KG]
Size [1x2]	Code	Dimensions [mm]					Pcs./Box	Pcs./Bags	Weight [Kg]
		L	L1						
1/8"	6331-018	38,0	13,0				55	5	0,0390
1/4"	6331-014	44,0	13,5				50	5	0,0780
3/8"	6331-038	47,5	15,0				50	5	0,0710
1/2"	6331-012	54,0	16,0				120	5	0,1250
3/4"	6331-034	58,0	17,0				60	5	0,1540
1"	6331-100	68,0	20,0				35	5	0,2520
1 1/4"	6331-114	74,5	22,0				35	5	0,3390
1 1/2"	6331-112	78,5	24,0				20	2	0,5680
2"	6331-200	90,0	27,0				16	2	0,7860
2 1/2"	6331-212	102,0	29,5				6	1	1,5800
3"	6331-300	113,0	31,0				4	1	2,0800

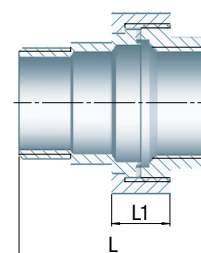

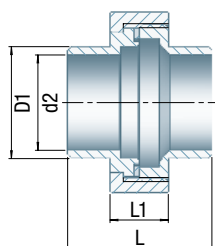

332

**BOCCHETTONE A SEDE PIANA CON ENTRAMBE  
ESTREMITÀ A SALDARE**  
Unions flat seat both ends welding

MAT. 1.4408

MISURE [1X2]	CODICE	DIMENSIONI [MM]				PZ/SCATOLA	PZ/BUSTA	PESO [KG]
Size [1x2]	Code	Dimensions [mm]				Pcs./Box	Pcs./Bags	Weight [Kg]
		L	L1	D1	d2			
1/4"	6332-014	35,5	13,5	13,5	8,8	50	10	0,0512
3/8"	6332-038	36,5	15,0	17,2	12,5	50	5	0,0620
1/2"	6332-012	39,5	16,0	21,3	16,0	50	5	0,1110
3/4"	6332-034	42,5	17,0	26,9	21,6	35	5	0,1290
1"	6332-100	50,0	20,0	33,7	27,2	40	5	0,2150
1 1/4"	6332-114	54,0	22,0	42,4	35,9	45	5	0,3200
1 1/2"	6332-112	58,0	24,0	48,3	41,8	20	5	0,4240
2"	6332-200	65,0	27,0	60,3	53,0	24	2	0,6000
2 1/2"	6332-212	75,0	29,5	76,1	68,8	5	1	1,2400
3"	6332-300	83,0	31,0	88,9	80,8	5	1	1,6400

333

**BOCCHETTONE A SEDE PIANA CON FILETTO  
MASCHIO/A SALDARE**  
Unions flat seat male thread/welding end

MAT. 1.4408

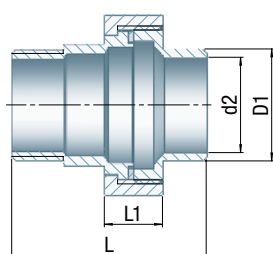

MISURE [1X2]	CODICE	DIMENSIONI [MM]				PZ/SCATOLA	PZ/BUSTA	PESO [KG]
Size [1x2]	Code	Dimensions [mm]				Pcs./Box	Pcs./Bags	Weight [Kg]
		L	L1	D1	d2			
1/4"	6333-014	45,0	13,5	13,5	8,8	50	5	0,1035
3/8"	6333-038	48,8	15,0	17,2	12,5	50	5	0,0710
1/2"	6333-012	56,3	16,0	21,3	16,0	30	5	0,1250
3/4"	6333-034	59,3	17,0	26,9	21,6	15	5	0,1540
1"	6333-100	69,0	20,0	33,7	27,2	35	5	0,2520
1 1/4"	6333-114	74,5	22,0	42,4	35,9	15	5	0,3390
1 1/2"	6333-112	78,0	24,0	48,3	41,8	20	2	0,5680
2"	6333-200	96,0	27,0	60,3	53,0	8	2	0,7860
2 1/2"	6333-212	99,3	29,5	76,1	68,8	2	1	1,5800

334

**BOCCHETTONE A SEDE PIANA CON FILETTO  
FEMMINA/A SALDARE**  
Unions flat seat female thread/welding end

MAT. 1.4408

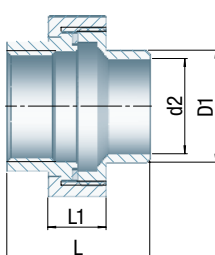

MISURE [1X2]	CODICE	DIMENSIONI [MM]				PZ/SCATOLA	PZ/BUSTA	PESO [KG]
Size [1x2]	Code	Dimensions [mm]				Pcs./Box	Pcs./Bags	Weight [Kg]
		L	L1	D1	d2			
1/4"	6334-014	34,5	13,5	13,5	8,8	50	10	0,0512
3/8"	6334-038	37,8	15,0	17,2	12,5	50	5	0,0780
1/2"	6334-012	41,8	16,0	21,3	16,0	50	5	0,1220
3/4"	6334-034	43,8	17,0	26,9	21,6	35	5	0,1650
1"	6334-100	51,0	20,0	33,7	27,2	40	5	0,2480
1 1/4"	6334-114	54,0	22,0	42,4	35,9	20	5	0,3480
1 1/2"	6334-112	57,5	24,0	48,3	41,8	20	5	0,5160
2"	6334-200	71,0	27,0	60,3	53,0	24	2	0,7760

335		BOCCHETTONE A SEDE PIANA, M/M Unions flat seat, M/M				MAT. 1.4408	
MISURE [1 X 2]	CODICE	DIMENSIONI [MM]		PZ/SCATOLA	PZ/BUSTA	PESO [KG]	
Size [1 x 2]	Code	Dimensions [mm]		Pcs./Box	Pcs./Bags	Weight [Kg]	
		L	L1				
1/2"	6335-012	68,5	16,0	25	5	0,1710	
3/4"	6335-034	73,5	17,0	10	5	0,2440	
1"	6335-100	86,0	20,0	5	5	0,3680	
1 1/4"	6335-114	95,0	22,0	10	2	0,5120	
1 1/2"	6335-112	99,0	24,0	15	5	0,6080	

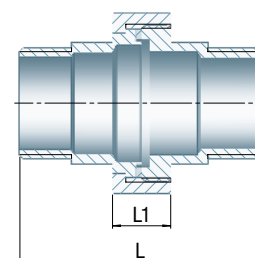

340		BOCCHETTONE A SEDE CONICA, F/F Unions conical seat, F/F				MAT. 1.4408	
MISURE [1 X 2]	CODICE	DIMENSIONI [MM]		PZ/SCATOLA	PZ/BUSTA	PESO [KG]	
Size [1 x 2]	Code	Dimensions [mm]		Pcs./Box	Pcs./Bags	Weight [Kg]	
		L	L1				
1/8"	6340-018	30,0	13,0	50	10	0,0400	
1/4"	6340-014	33,5	13,5	50	10	0,0580	
3/8"	6340-038	36,5	15,0	50	5	0,0780	
1/2"	6340-012	39,5	16,0	200	5	0,1220	
3/4"	6340-034	42,5	17,0	140	5	0,1650	
1"	6340-100	50,0	20,0	84	2	0,2480	
1 1/4"	6340-114	54,0	22,0	45	5	0,3480	
1 1/2"	6340-112	58,0	24,0	45	5	0,5160	
2"	6340-200	65,0	27,0	24	2	0,7760	
2 1/2"	6340-212	75,0	29,5	5	1	1,2000	
3"	6340-300	83,0	31,0	5	1	1,5920	
4"	6340-400	110,0	34,0	4	1	2,4800	

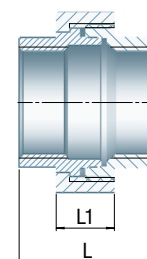

341		BOCCHETTONE A SEDE CONICA, M/F Unions conical seat, M/F				MAT. 1.4408	
MISURE [1 X 2]	CODICE	DIMENSIONI [MM]		PZ/SCATOLA	PZ/BUSTA	PESO [KG]	
Size [1 x 2]	Code	Dimensions [mm]		Pcs./Box	Pcs./Bags	Weight [Kg]	
		L	L1				
1/8"	6341-018	38,0	13,0	55	5	0,0390	
1/4"	6341-014	44,0	13,5	50	5	0,1035	
3/8"	6341-038	47,5	15,0	50	5	0,0710	
1/2"	6341-012	54,0	16,0	120	5	0,1250	
3/4"	6341-034	58,0	17,0	60	5	0,1540	
1"	6341-100	68,0	20,0	35	5	0,2520	
1 1/4"	6341-114	74,5	22,0	35	5	0,3390	
1 1/2"	6341-112	78,5	24,0	20	2	0,5680	
2"	6341-200	90,0	27,0	16	2	0,7860	
2 1/2"	6341-212	102,0	29,5	6	1	1,5800	
3"	6341-300	113,0	31,0	2	1	2,0800	

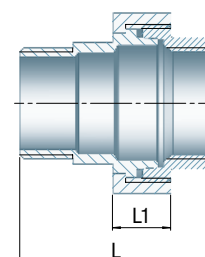



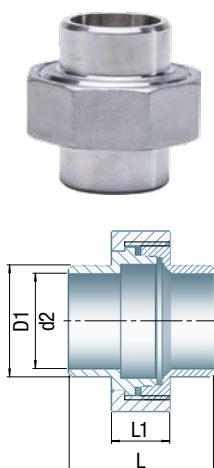

342		BOCCHETTONE A SEDE CONICA CON ENTRAMBE ESTREMITÀ A SALDARE				Unions conical seat both ends welding		MAT. 1.4408	
MISURE [1X2]	CODICE	DIMENSIONI [MM]				PZ/SCATOLA	PZ/BUSTA	PESO [KG]	
Size [1x2]	Code	Dimensions [mm]				Pcs./Box	Pcs./Bags	Weight [Kg]	
		L	L1	D1	d2				
1/4"	6342-014	35,5	13,5	13,5	8,8	50	10	0,0510	
3/8"	6342-038	38,0	15,0	17,2	12,5	50	5	0,0620	
1/2"	6342-012	44,0	16,0	21,3	16,0	50	5	0,1110	
3/4"	6342-034	45,0	17,0	26,9	21,6	35	5	0,1290	
1"	6342-100	50,0	20,0	33,7	27,2	20	5	0,2150	
1 1/4"	6342-114	55,0	22,0	42,4	35,9	10	5	0,3200	
1 1/2"	6342-112	57,0	24,0	48,3	41,8	45	5	0,4240	
2"	6342-200	65,0	27,0	60,3	53,0	12	2	0,6000	
2 1/2"	6342-212	71,0	29,5	76,1	68,8	5	1	1,2400	
3"	6342-300	80,0	31,0	88,9	80,8	5	1	1,6400	



343		BOCCHETTONE A SEDE CONICA CON FILETTO MASCHIO/A SALDARE				Unions conical seat, male thread/welding end		MAT. 1.4408	
MISURE [1X2]	CODICE	DIMENSIONI [MM]				PZ/SCATOLA	PZ/BUSTA	PESO [KG]	
Size [1x2]	Code	Dimensions [mm]				Pcs./Box	Pcs./Bags	Weight [Kg]	
		L	L1	D1	d2				
1/4"	6343-014	45,0	13,5	13,5	8,8	50	5	0,1035	
3/8"	6343-038	48,8	15,0	17,2	12,5	50	5	0,0710	
1/2"	6343-012	56,3	16,0	21,3	16,0	30	5	0,1250	
3/4"	6343-034	59,3	17,0	26,9	21,6	15	5	0,1540	
1"	6343-100	69,0	20,0	33,7	27,2	35	5	0,2520	
1 1/4"	6343-114	74,5	22,0	42,4	35,9	15	5	0,3390	
1 1/2"	6343-112	78,0	24,0	48,3	41,8	20	2	0,5680	
2"	6343-200	96,0	27,0	60,3	53,0	8	2	0,7860	

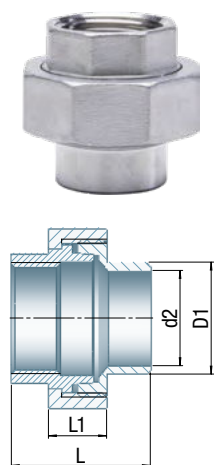

344		BOCCHETTONE A SEDE CONICA CON FILETTO FEMMINA/A SALDARE				Unions conical seat, female thread/welding end		MAT. 1.4408	
MISURE [1X2]	CODICE	DIMENSIONI [MM]				PZ/SCATOLA	PZ/BUSTA	PESO [KG]	
Size [1x2]	Code	Dimensions [mm]				Pcs./Box	Pcs./Bags	Weight [Kg]	
		L	L1	D1	d2				
1/4"	6344-014	34,5	13,5	13,5	8,8	50	10	0,0512	
3/8"	6344-038	37,8	15,0	17,2	12,5	50	5	0,0780	
1/2"	6344-012	41,8	16,0	21,3	16,0	50	5	0,1220	
3/4"	6344-034	43,8	17,0	26,9	21,6	35	5	0,1650	
1"	6344-100	51,0	20,0	33,7	27,2	20	5	0,2480	
1 1/4"	6344-114	54,0	22,0	42,4	35,9	20	5	0,3480	
1 1/2"	6344-112	57,5	24,0	48,3	41,8	20	5	0,5160	
2"	6344-200	71,0	27,0	60,3	53,0	24	2	0,7760	

345		BOCCHETTONE A SEDE CONICA, M/M Unions conical seat, M/M				MAT. 1.4408	
MISURE [1 X 2]	CODICE	DIMENSIONI [MM]		PZ/SCATOLA	PZ/BUSTA	PESO [KG]	
Size [1 x 2]	Code	Dimensions [mm]		Pcs./Box	Pcs./Bags	Weight [Kg]	
		L	L1				
1/2"	6345-012	68,5	16,0	25	5	0,1710	
3/4"	6345-034	73,5	17,0	12	2	0,2440	
1"	6345-100	86,0	20,0	6	2	0,3680	
2"	6345-200	115,0	27,0	7	1	0,9840	

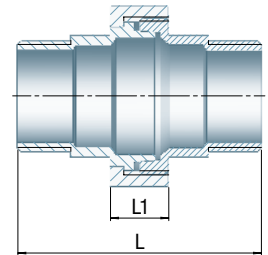

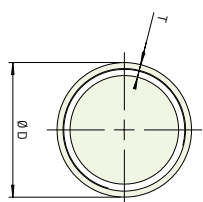
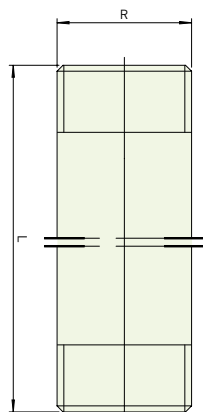

**VITE DI PROLUNGAMENTO IN ACCIAIO INOX**  
**Barrel Nipple** **MAT. 1.4404**

FILETTO ISO 7/1 (R) X LUNGHEZZA (L) Thread ISO 7/1 (R) x Length (L)	Ø-ESTERNO DEL TUBO (D) X SPESSORE PARETE (T) Pipe-outer-Ø (D) x Wall thickness (T)	CODICE Code	PZ/SCATOLA Pcs./Box	PZ/ BUSTA Pcs./ BAGS	PESO [KG] Weight [Kg]
1/8" x 40 mm	10,2 x 2,0 mm	<b>6070.040.01</b>	800	10	0,0140
1/8" x 60 mm	10,2 x 2,0 mm	<b>6070.060.01</b>	500	10	0,0200
1/8" x 100 mm	10,2 x 2,0 mm	<b>6070.100.01</b>	200	10	0,0320
1/4" x 30 mm	13,5 x 2,3 mm	<b>6070.030.02</b>	600	10	0,0180
1/4" x 40 mm	13,5 x 2,3 mm	<b>6070.040.02</b>	600	10	0,0230
1/4" x 60 mm	13,5 x 2,3 mm	<b>6070.060.02</b>	500	10	0,0330
1/4" x 80 mm	13,5 x 2,3 mm	<b>6070.080.02</b>	300	10	0,0440
1/4" x 100 mm	13,5 x 2,3 mm	<b>6070.100.02</b>	250	10	0,0540
1/4" x 120 mm	13,5 x 2,3 mm	<b>6070.120.02</b>	200	10	0,0640
1/4" x 150 mm	13,5 x 2,3 mm	<b>6070.150.02</b>	150	10	0,0800
1/4" x 200 mm	13,5 x 2,3 mm	<b>6070.200.02</b>	100	5	0,1060
3/8" x 40 mm	17,2 x 2,3 mm	<b>6070.040.03</b>	500	10	0,0310
3/8" x 60 mm	17,2 x 2,3 mm	<b>6070.060.03</b>	400	10	0,0450
3/8" x 80 mm	17,2 x 2,3 mm	<b>6070.080.03</b>	300	10	0,0590
3/8" x 100 mm	17,2 x 2,3 mm	<b>6070.100.03</b>	250	10	0,0740
3/8" x 120 mm	17,2 x 2,3 mm	<b>6070.120.03</b>	200	10	0,0880
3/8" x 150 mm	17,2 x 2,3 mm	<b>6070.150.03</b>	150	10	0,1090
3/8" x 200 mm	17,2 x 2,3 mm	<b>6070.200.03</b>	100	5	0,1440
1/2" x 40 mm	21,3 x 2,6 mm	<b>6070.040.04</b>	250	10	0,0430
1/2" x 60 mm	21,3 x 2,6 mm	<b>6070.060.04</b>	250	10	0,0620
1/2" x 80 mm	21,3 x 2,6 mm	<b>6070.080.04</b>	200	10	0,0810
1/2" x 100 mm	21,3 x 2,6 mm	<b>6070.100.04</b>	150	10	0,1000
1/2" x 120 mm	21,3 x 2,6 mm	<b>6070.120.04</b>	100	10	0,1200
1/2" x 150 mm	21,3 x 2,6 mm	<b>6070.150.04</b>	80	10	0,1490
1/2" x 200 mm	21,3 x 2,6 mm	<b>6070.200.04</b>	50	5	0,1970
1/2" x 300 mm	21,3 x 2,6 mm	<b>6070.300.04</b>	40	5	0,2940
3/4" x 40 mm	26,9 x 2,6 mm	<b>6070.040.05</b>	150	10	0,0550
3/4" x 60 mm	26,9 x 2,6 mm	<b>6070.060.05</b>	150	10	0,0800
3/4" x 80 mm	26,9 x 2,6 mm	<b>6070.080.05</b>	100	10	0,1050
3/4" x 100 mm	26,9 x 2,6 mm	<b>6070.100.05</b>	80	10	0,1300
3/4" x 120 mm	26,9 x 2,6 mm	<b>6070.120.05</b>	60	10	0,1550
3/4" x 150 mm	26,9 x 2,6 mm	<b>6070.150.05</b>	50	5	0,1930
3/4" x 200 mm	26,9 x 2,6 mm	<b>6070.200.05</b>	40	5	0,2560
3/4" x 300 mm	26,9 x 2,6 mm	<b>6070.300.05</b>	20	5	0,3810
1" x 40 mm	33,7 x 3,2 mm	<b>6070.040.06</b>	100	10	0,0830
1" x 60 mm	33,7 x 3,2 mm	<b>6070.060.06</b>	100	10	0,1210
1" x 80 mm	33,7 x 3,2 mm	<b>6070.080.06</b>	60	10	0,1590
1" x 100 mm	33,7 x 3,2 mm	<b>6070.100.06</b>	50	5	0,1970
1" x 120 mm	33,7 x 3,2 mm	<b>6070.120.06</b>	40	5	0,2350
1" x 150 mm	33,7 x 3,2 mm	<b>6070.150.06</b>	30	5	0,2920
1" x 200 mm	33,7 x 3,2 mm	<b>6070.200.06</b>	20	5	0,3860
1" x 300 mm	33,7 x 3,2 mm	<b>6070.300.06</b>	10	5	0,5760
1 1/4" x 40 mm	42,4 x 3,2 mm	<b>6070.040.07</b>	50	5	0,1090
1 1/4" x 60 mm	42,4 x 3,2 mm	<b>6070.060.07</b>	50	5	0,1580
1 1/4" x 80 mm	42,4 x 3,2 mm	<b>6070.080.07</b>	50	5	0,2070
1 1/4" x 100 mm	42,4 x 3,2 mm	<b>6070.100.07</b>	40	5	0,2550
1 1/4" x 120 mm	42,4 x 3,2 mm	<b>6070.120.07</b>	30	5	0,3040
1 1/4" x 150 mm	42,4 x 3,2 mm	<b>6070.150.07</b>	20	5	0,3770
1 1/4" x 200 mm	42,4 x 3,2 mm	<b>6070.200.07</b>	10	5	0,4980

Tubi saldati secondo DIN EN 10255  
 Welded pipes according to DIN EN 10255

VITE DI PROLUNGAMENTO IN ACCIAIO INOX  
Barrel Nipple

MAT. 1.4404

FILETTO ISO 7/1 (R) X LUNGHEZZA (L) Thread ISO 7/1 (R) x Length (L)	Ø-ESTERNO DEL TUBO (D) X SPESSORE PARETE (T) Pipe-outer-Ø (D) x Wall thickness (T)	CODICE Code	PZ/SCATOLA Pcs./Box	PZ/ BUSTA Pcs./ BAGS	PESO [KG] Weight [Kg]
1 1/2" x 40 mm	48,3 x 3,2 mm	6070.040.08	40	5	0,1260
1 1/2" x 60 mm	48,3 x 3,2 mm	6070.060.08	40	5	0,1820
1 1/2" x 80 mm	48,3 x 3,2 mm	6070.080.08	40	5	0,2370
1 1/2" x 100 mm	48,3 x 3,2 mm	6070.100.08	30	5	0,2930
1 1/2" x 120 mm	48,3 x 3,2 mm	6070.120.08	20	5	0,3490
1 1/2" x 150 mm	48,3 x 3,2 mm	6070.150.08	15	5	0,4330
1 1/2" x 200 mm	48,3 x 3,2 mm	6070.200.08	10	5	0,5730
2" x 40 mm	60,3 x 3,6 mm	6070.040.09	20	5	0,1840
2" x 60 mm	60,3 x 3,6 mm	6070.060.09	20	5	0,2660
2" x 80 mm	60,3 x 3,6 mm	6070.080.09	20	5	0,3470
2" x 100 mm	60,3 x 3,6 mm	6070.100.09	20	5	0,4290
2" x 120 mm	60,3 x 3,6 mm	6070.120.09	10	5	0,5110
2" x 150 mm	60,3 x 3,6 mm	6070.150.09	10	5	0,6330
2" x 200 mm	60,3 x 3,6 mm	6070.200.09	10	2	0,8380
2 1/2" x 100 mm	76,1 x 3,6 mm	6070.100.10	16	4	0,6280
2 1/2" x 120 mm	76,1 x 3,6 mm	6070.120.10	16	2	0,7470
2 1/2" x 150 mm	76,1 x 3,6 mm	6070.150.10	10	2	0,9250
3" x 120 mm	88,9 x 4,0 mm	6070.120.11	8	2	0,8800
3" x 150 mm	88,9 x 4,0 mm	6070.150.11	6	2	1,0890
3" x 200 mm	88,9 x 4,0 mm	6070.200.11	4	1	1,4380
4" x 100 mm	114,3 x 4,5 mm	6070.100.12	4	1	1,1910
4" x 120 mm	114,3 x 4,5 mm	6070.120.12	4	1	1,4160

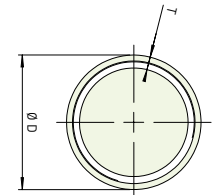
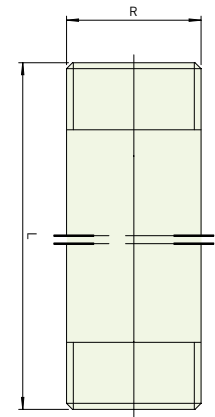

NIPPLA A SALDARE CON FILETTATURA UNILATERALE  
Welding Nipple

MAT. 1.4404

FILETTO ISO 7/1 (R) X LUNGHEZZA (L) Thread ISO 7/1 (R) x Length (L)	Ø-ESTERNO DEL TUBO (D) X SPESSORE PARETE (T) Pipe-outer-Ø (D) x Wall thickness (T)	CODICE Code	PZ/SCATOLA Pcs./Box	PZ/ BUSTA Pcs./ BAGS	PESO [KG] Weight [Kg]
1/8" x 30 mm	10,2 x 2,0 mm	6072.030.01	1500	10	0,0110
1/4" x 30 mm	13,5 x 2,3 mm	6072.030.02	1000	10	0,0180
3/8" x 30 mm	17,2 x 2,3 mm	6072.030.03	600	10	0,0240
1/2" x 35 mm	21,3 x 2,6 mm	6072.035.04	400	10	0,0380
3/4" x 40 mm	26,9 x 2,6 mm	6072.040.05	200	10	0,0550
1" x 40 mm	33,7 x 3,2 mm	6072.040.06	120	10	0,0830
1 1/4" x 50 mm	42,4 x 3,2 mm	6072.050.07	60	5	0,1340
1 1/2" x 50 mm	48,3 x 3,2 mm	6072.050.08	60	5	0,1540
2" x 50 mm	60,3 x 3,6 mm	6072.050.09	36	6	0,2250
2 1/2" x 60 mm	76,1 x 3,6 mm	6072.060.10	16	4	0,3920
3" x 70 mm	88,9 x 4,0 mm	6072.070.11	12	4	0,5310
4" x 80 mm	114,3 x 4,5 mm	6072.080.12	8	2	0,9660

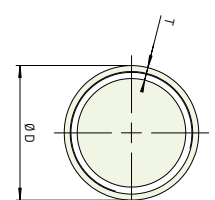
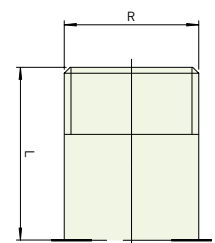

Tubi saldati secondo DIN EN 10255  
Welded pipes according to DIN EN 10255

**TIPO 610**

**1/2"-2" FILTRO A „Y“ IN ACCIAIO INOX**

- Filtro a Y con estremità filettate femmina secondo DIN EN 10226-1 / ISO 7-1
- Design: sede obliqua
- Applicazioni: acqua calda e fredda
- Temperatura di esercizio: -20°C ÷ +180°C
- Pressione di esercizio: max. 40 bar
- Filtro a rete MW 1 mm
- Inserto filtrante con la guarnizione, disponibile come pezzo di ricambio

**1/2"-2" Y-STRAINER MADE OF STAINLESS STEEL**

- Y-Strainer with threaded female ends DIN EN 10226-1 / ISO 7-1
- Design: angle seat
- Media: Water warm and cold
- Operating temperature: -20°C ÷ +180°C
- Operating pressure: max. 40 bar
- Filter screen MW 1 mm
- Screen insert with sealing as spare part available



**610**

**FILTRO A „Y“ IN ACCIAIO INOX, F/F**  
Y-Strainer with threaded female ends

MISURE	CODICE	PREZZO	DIMENSIONI [MM]					
Size	Code	Price	Dimensions [mm]					
			A	L	D	W	H	KG/PZ
1/2"	<b>610-012</b>	<b>16,18</b>	15	65	1	2	39	0.225
3/4"	<b>610-034</b>	<b>23,47</b>	20	80	1	2	45	0.322
1"	<b>610-100</b>	<b>34,58</b>	25	90	1	2	52	0.540
1 1/4"	<b>610-114</b>	<b>45,79</b>	32	105	1	2	58	0.723
1 1/2"	<b>610-112</b>	<b>61,82</b>	40	120	1	2	72	1.020
2"	<b>610-200</b>	<b>83,66</b>	50	140	1	2	80	1.426

**SET DI RICAMBIO A RETINA IN ACCIAIO INOX CON GUARNIZIONE**  
Spare part set sealing + filter screen

PER FILTRO A „Y“	CODICE
For size Y-Strainer	Code
1/2"	<b>610-012E</b>
3/4"	<b>610-034E</b>
1"	<b>610-100E</b>
1 1/4"	<b>610-114E</b>
1 1/2"	<b>610-112E</b>
2"	<b>610-200E</b>

N°	COMPONENTI	Parts	Q.TÀ QTY	MATERIALE Material
1	CORPO	Body	1	CF8 - CF8M
2	TAPPO	Cap	1	CF8 - CF8M
3	FILTRO	Screen	1	AISI 316
4	GUARNIZIONE	Gasket	1	PTFE

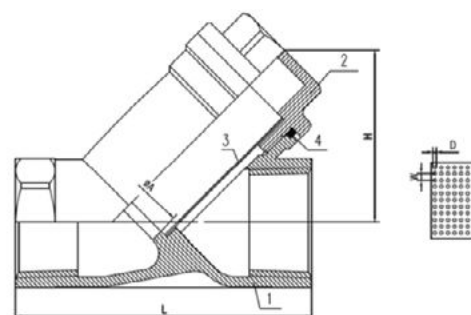

TIPO 603

1/4"-2" VALVOLA A SFERA AD 1 PEZZO

- Filettatura femmina a passaggio ridotto e maniglia con bloccaggio di sicurezza
- Stelo a prova di esplosione
- Corpo in microfusione
- Pressione massima: PN 63

1/4"-2" 1 PC BALL VALVE

- Female thread reduced bore and lock handle
- Blow-out proof stem
- Investment casting body
- Max. pressure stage: PN 63

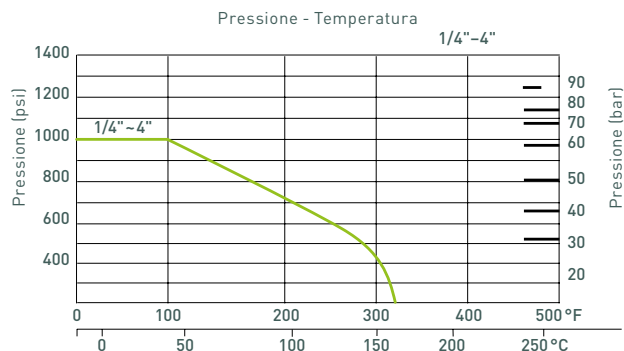

603

VALVOLA A SFERA AD 1 PEZZO, PASSAGGIO RIDOTTO,  
MANIGLIA CON BLOCCAGGIO DI SICUREZZA, FILETTO F/F  
1 pc. ball valve. female thread. reduced bore. lock handle

MAT. 1.4408

MISURE	CODICE	DIMENSIONI [MM]						PZ/SCATOLA	PZ/BUSTA	PESO [KG]
Size	Code	Dimensions [mm]						Pcs./Box	Pcs./Bags	Weight [Kg]
		d	L	L1	H	W	S			
1/4"	603-014	5.0	39.0	19.0	30.0	70.0	17.0	120	1	0,0600
3/8"	603-038	6.8	44.0	21.0	34.0	90.0	21.0	120	1	0,1000
1/2"	603-012	9.2	56.5	27.5	41.0	100.0	25.0	80	1	0,1750
3/4"	603-034	12.5	59.0	29.0	44.0	100.0	32.0	50	1	0,2400
1"	603-100	15.0	71.0	34.5	50.0	110.0	38.0	36	1	0,3900
1 1/4"	603-114	20.0	78.0	37.0	55.0	110.0	48.0	20	1	0,6100
1 1/2"	603-112	25.0	83.0	40.0	64.0	135.0	53.0	10	1	0,7600
2"	603-200	32.0	100.0	49.0	70.0	145.0	65.0	6	1	1,1750

N°.	COMPONENTI	Parts	Q.TÀ QTY	MATERIALE CF8M
1	CORPO	Body	1	ASTM - A351 - CF8M
2	INSERTO	Insert	1	ASTM - A351 - CF8M
3	ANELLO DI SEDE	Ball seat	2	PTFE
4	SFERA	Ball	1	ASTM - A351 - CF8M
5	RONDELLA DI SPINTA	Thrust washer	1	PTFE
6	TENUTA STELO	Stem packing	1	PTFE
7	GUARNIZIONE STELO	Stem washer	1	AISI 304
8	STELO	Stem	1	AISI 316
9	RONDELLA	Spring washer	1	AISI 304
10	DADO LEVA	Stem nut	1	AISI 304
11	LUCCHETTO DI SICUREZZA	Lock device	1	AISI 304
12	LEVA	Handle	1	AISI 304
13	COPERTURA LEVA	Plastic cover	1	PLASTIC

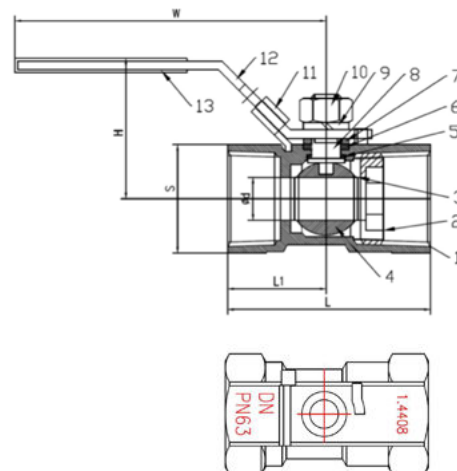

## TIPO 605

### 1/4"-4" VALVOLA A SFERA A 2 PEZZI

- Filettatura femmina a passaggio totale
- Stelo a prova di esplosione
- Corpo in microfusione
- Pressione massima: PN 63

### 1/4"-4" 2 PCS ECO BALL VALVE

- Female thread full bore
- Blow-out proof stem
- Investment casting body
- Max. pressure stage: PN 63

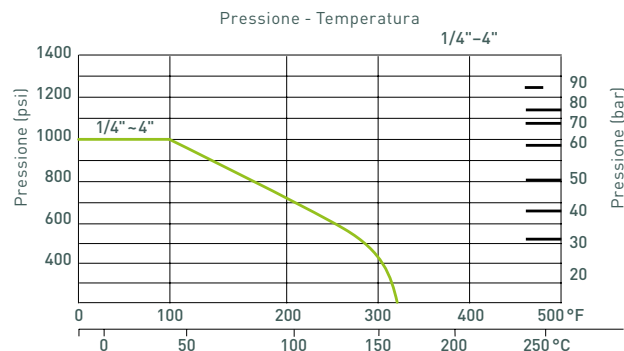

605

**VALVOLA A SFERA A 2 PEZZI, PASSAGGIO TOTALE, MANIGLIA CON BLOCCAGGIO DI SICUREZZA, FILETTO F/F**  
2 Pcs. Eco ball valve. female thread. full bore. lock handle

MAT. 1.4408

MISURE	CODICE	DIMENSIONI [MM]				PZ/SCATOLA	PZ/BUSTA	PESO [KG]
Size	Code	Dimensions [mm]				Pcs./Box	Pcs./Bags	Weight [Kg]
		L	D	H	W			
1/4"	605-014	49.0	11.6	48.0	95.0	70	1	0,2200
3/8"	605-038	49.0	12.7	48.0	95.0	60	1	0,2000
1/2"	605-012	57.0	15.0	48.5	95.0	50	1	0,2080
3/4"	605-034	65.0	20.0	54.5	108.0	34	1	0,3190
1"	605-100	77.0	25.0	58.0	108.0	16	1	0,4900
1 1/4"	605-114	90.0	32.0	70.5	130.0	12	1	0,7920
1 1/2"	605-112	98.0	38.0	76.0	130.0	8	1	1,5000
2"	605-200	121.0	50.0	83.5	165.0	5	1	2,0570
2 1/2"	605-212	145.0	65.0	125.0	215.0	2	1	4,2800
3"	605-300	166.0	80.0	136.0	215.0	4	1	6,4000
4"	605-400	198.0	100.0	165.0	270.0	2	1	16,2000

N°.	COMPONENTI	Parts	Q.TÀ QTY	MATERIALE CF8M
1	CORPO	Body	1	ASTM - A351 - CF8M
2	CAPPUCCIO	Cap	1	ASTM - A351 - CF8M
3	SFERA	Ball	1	ASTM - A351 - CF8M
4	ANELLO DI SEDE	Ball seat	2	PTFE
5	GUARNIZIONE	Joint gasket	1	PTFE
6	STELO	Stem	1	AISI 316
7	RONDELLA DI SPINTA	Thrust washer	1	PTFE
8	TENUTA STELO	Stem packing	1	PTFE
9	PRESSA TRECCIA	Gland nut	1	AISI 304
10	LEVA	Handle	1	AISI 304
11	GUARNIZIONE	Stem washer	1	AISI 304
12	DADO LEVA	Stem nut	1	AISI 304
13	COPERTURA LEVA	Plastic cover	1	PLASTICO

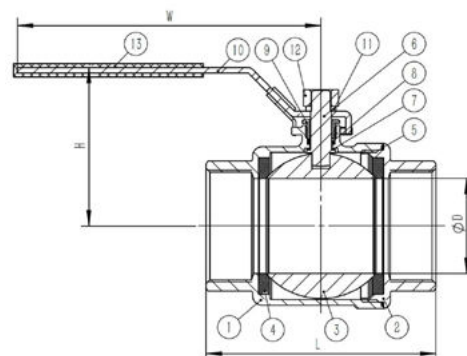

TIPO 608

1/4"-4" VALVOLA A SFERA A 3 PEZZI

- Filettatura femmina a passaggio totale e maniglia con bloccaggio di sicurezza
- Stelo a prova di esplosione
- Corpo in microfusione
- Pressione massima: PN 63
- Opzionale: lucchetto di sicurezza

1/4"-4" 3 PCS BALL VALVE

- Female thread full bore and lock handle
- Blow-out proof stem
- Investment casting body
- Pressione massima: PN 63
- Option: Locking device

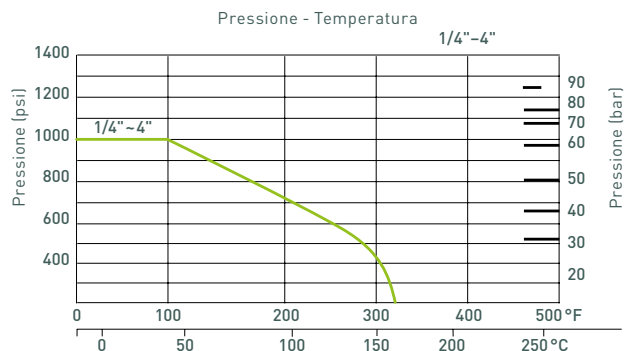

608

VALVOLA A SFERA A 3 PEZZI, PASSAGGIO TOTALE, MANIGLIA CON BLOCCAGGIO DI SICUREZZA, FILETTO F/F  
3 Pcs. ball valve. female thread. full bore. lock handle

MAT. 1.4408

MISURE	CODICE	DIMENSIONI [MM]				PZ/SCATOLA	PZ/BUSTA	PESO [KG]
Size	Code	Dimensions [mm]				Pcs./Box	Pcs./Bags	Weight [Kg]
ISO TOP		Ød	L	H	W			
1/4"	608-014	11.6	59.0	51.0	95.0	50	1	0,3200
3/8"	608-038	12.7	59.0	51.0	95.0	50	1	0,3300
DIN 3202 M3								
1/2"	608-012	15.0	75.0	55.0	95.0	30	1	0,4740
3/4"	608-034	20.0	80.0	59.0	110.0	20	1	0,6510
1"	608-100	25.0	90.0	73.0	135.0	10	1	0,9110
1 1/4"	608-114	32.0	110.0	78.0	135.0	6	1	1,4660
1 1/2"	608-112	38.0	120.0	91.0	147.0	5	1	2,0730
2"	608-200	50.0	140.0	99.0	165.0	2	1	3,4920
2 1/2"	608-212	65.0	185.0	130.0	215.0	6	1	6,5640
3"	608-300	80.0	205.0	142.0	215.0	3	1	10,4800
4"	608-400	100.0	240.0	174.0	310.0	1	1	20,4700

Articoli DIN3202 M3

Disegno tecnico per articoli DIN3202 M3

Articoli ISO TOP\*

N°.	COMPONENTI	Parts	Q.TÀ QTY	MATERIALE
1	CORPO	Body	1	ASTM-A351-CF8M
2	CAPPUCCIO	Cap	2	ASTM-A351-CF8M
3	SFERA	Ball	1	ASTM-A351-CF8M
4	ANELLO DI SEDE	Ball seat	2	PTFE
5	STELO	Stem	1	AISI 316
6	RONDELLA DI SPINTA	Thrust washer	1	PTFE
7	TENUTA STELO	Stem packing	2	PTFE
8	PRESSA TRECCIA	Gland nut	1	AISI 304
9	LEVA	Handle	1	AISI 304
10	GUARNIZIONE STELO	Stem washer	1	AISI 304
11	DADO LEVA	Stem nut	1	AISI 304
12	COPERTURA LEVA	Plastic cover	1	PLASTIC
13	BULLONE	Bolt	6	AISI 304
14	RONDELLA	Spring washer	6	AISI 304
15	BULLONE ESAGONALE	Hex nut	6	AISI 304

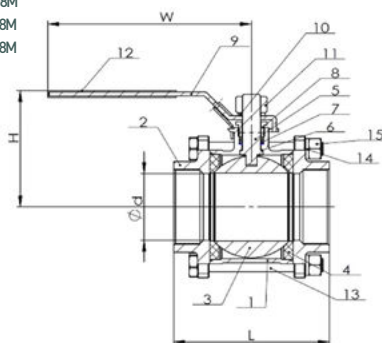

N°.	COMPONENTI	Parts	Q.TÀ QTY	MATERIALE
1	BULLONE	Bolt	4-6	AISI 304
2	ANELLO DI SEDE	Ball seat	2	PTFE
3	CORPO	Body	1	ASTM-A351-CF8M
4	SFERA	Ball	1	ASTM-A351-CF8M
5	GUARNIZIONE	Joint gasket	2	PTFE
6	CAPPUCCIO	Cap	2	ASTM-A351-CF8M
7	RONDELLA	Spring washer	4-6	AISI 304
8	BULLONE ESAGONALE	Hex nut	4-6	AISI 304
9	RONDELLA DI SPINTA	Thrust washer	1	PTFE
10	STELO	Stem	1	AISI 316
11	TENUTA STELO	Stem packing	1	PTFE
12	PRESSA TRECCIA	Gland nut	1	AISI 304
13	LEVA	Handle	1	AISI 304
14	GUARNIZIONE STELO	Stem washer	1	AISI 304
15	DADO LEVA	Stem nut	1	AISI 304
16	LUCCHETTO DI SICUREZZA	Lock device	1	AISI 304
17	COPERTURA LEVA	Plastic cover	1	PLASTIC